



**SPECIAL FEATURES:**

- \*Monster Power
- \*The Best Size for On-Road & Touring Car
- \*Special "Power Increasing Gear System"
- \*Powered by Two High Torque 540 Motors
- \*Either 2x7.2v Batteries or 1x12v Battery Can Be Used
- \*Glow Plug Stay Included
- \*On/Off Switch for Easy Usage



**A. ギヤとスターターホイルの組立て**

**A Gear & Starter Wheel Assembly**

No.	Parts Description	Qty.
1	Reduction Gear	1
2	Bearing 5x11x4mm	2
3	Stool Post	1
4	Nylon Washer	1
5	Nylon Coller	1

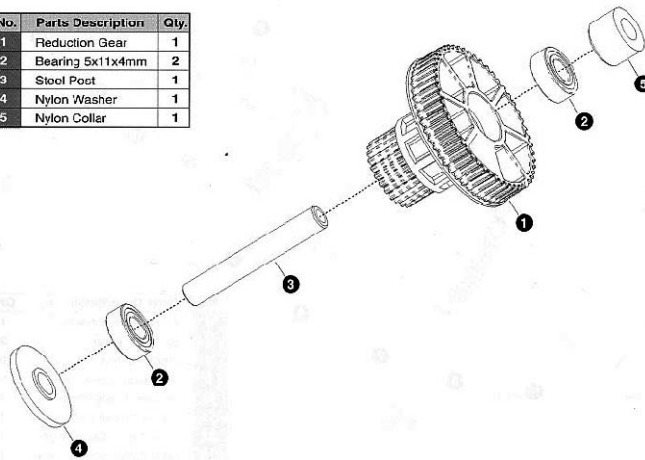

**B. モーターマウントの組立て**

**B Motor & Motor Mount Assembly**

No.	Parts Description	Qty.
14	Alum. Pulley	2
15	Motor	2
16	Set Screw 3x3mm	2

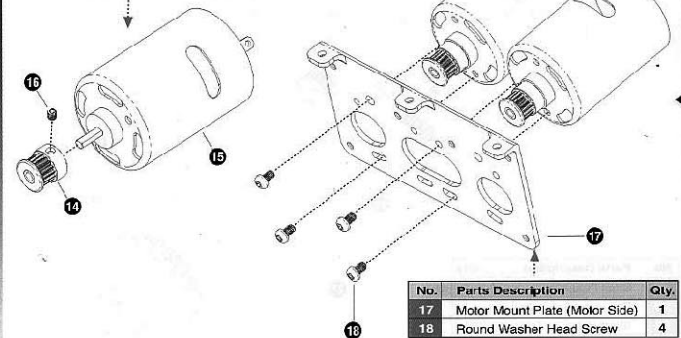

No.	Parts Description	Qty.
17	Motor Mount Plate (Motor Side)	1
18	Round Washer Head Screw	4

No.	Parts Description	Qty.
6	Alpha Starter Wheel	1
7	53T Main Gear	2
8	3mm Flat Nut	6
9	Flat Head Screw 3x6mm	6
10	Bearing 10x26x8mm	2
11	Starter Wheel Post	1
12	Short Nylon Cone Washer	1
13	Long Nylon Cone Washer	1

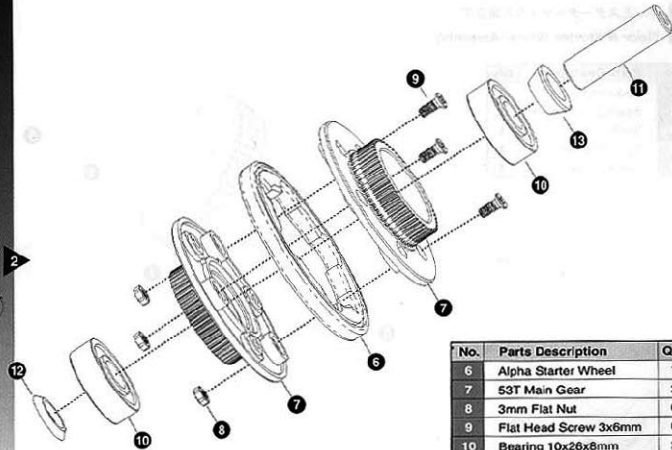

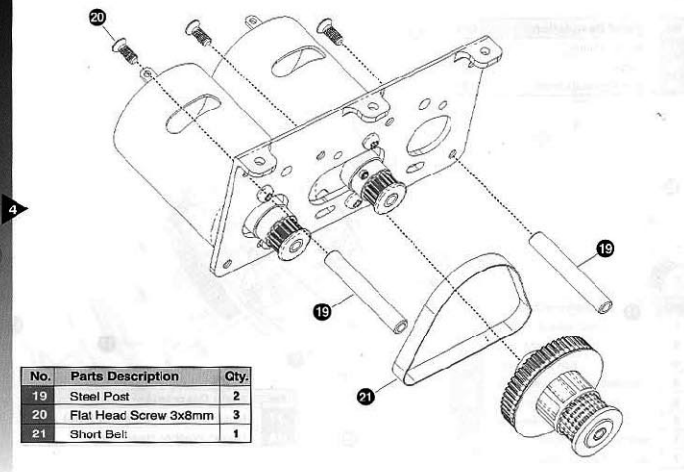

No.	Parts Description	Qty.
19	Steel Post	2
20	Flat Head Screw 3x8mm	3
21	Short Belt	1

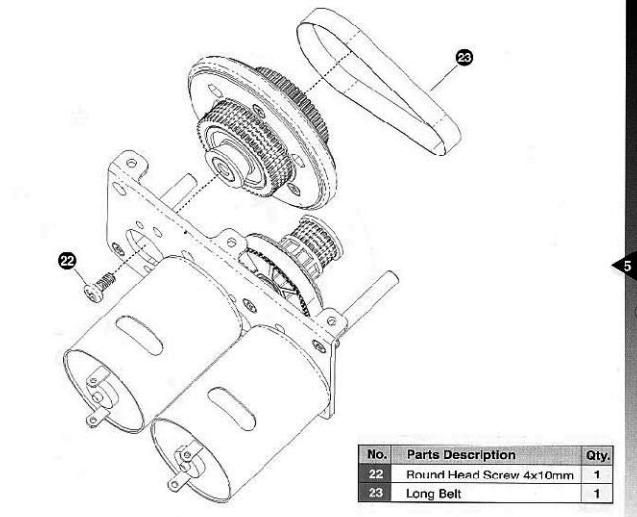

No.	Parts Description	Qty.
22	Round Head Screw 4x10mm	1
23	Long Belt	1

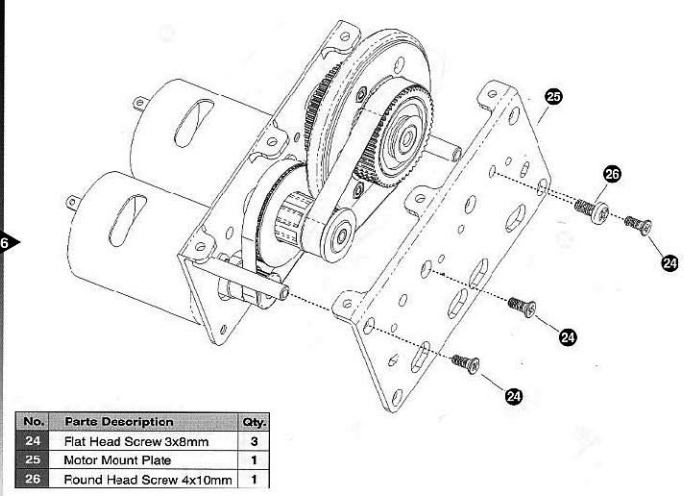

No.	Parts Description	Qty.
24	Flat Head Screw 3x8mm	3
25	Motor Mount Plate	1
26	Found Haad Screw 4x10mm	1

C. ローケースの組立て  
C Lower Case Assembly

No.	Parts Description	Qty.
27	Lower Case	1
28	Rubber Cap	4

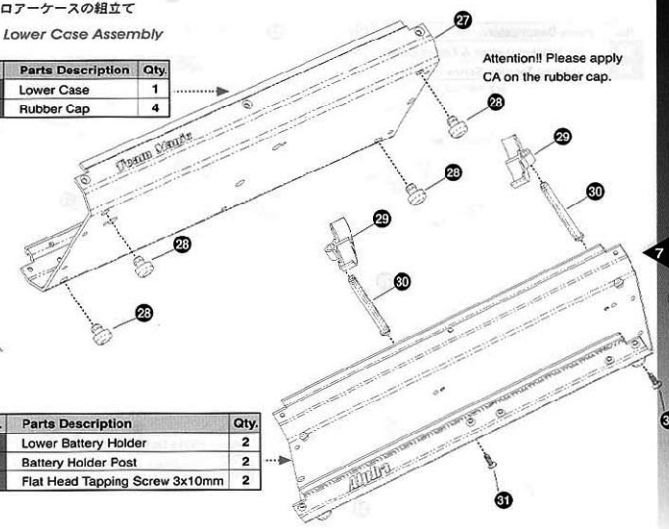

No.	Parts Description	Qty.
29	Lower Battery Holder	2
30	Battery Holder Post	2
31	Flat Head Tapping Screw 3x10mm	2

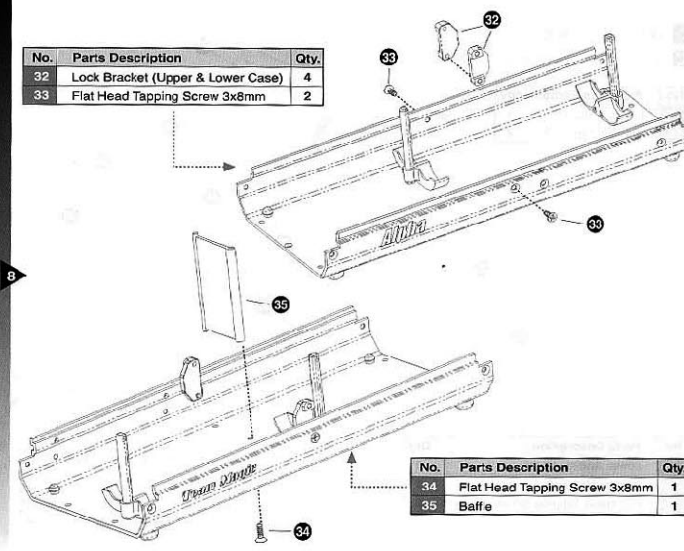

No.	Parts Description	Qty.
32	Lock Bracket (Upper & Lower Case)	4
33	Flat Head Tapping Screw 3x8mm	2

No.	Parts Description	Qty.
34	Flat Head Tapping Screw 3x8mm	1
35	Baffle	1

D. アッパーケース後部の組立て  
D Upper Case (Rear) Assembly

No.	Parts Description	Qty.
36	Upper Case (Rear)	1
37	Upper Case Lock	2
38	Flat Head Screw 3x8mm	2

Attention!! The upper case lock should be allowed to move forward & backward. Please tighten the two screws adequately.

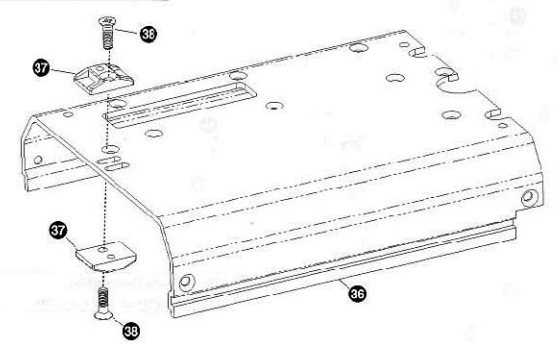

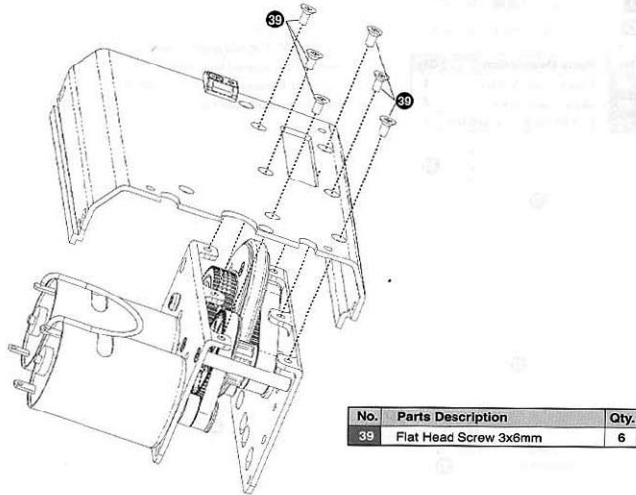

No.	Parts Description	Qty.
39	Flat Head Screw 3x8mm	6

E. アッパーケース前部の組立て

E Upper Case (Front) Assembly

No.	Parts Description	Qty.
40	Front Chassis Bracket (Type A)	2
41	Front Chassis Bracket (Type B)	1
42	Lower Chassis Bracket Post	2
43	Upper Chassis Bracket Post	2
44	Flat Head Screw 3x8mm	2

Attention!! Two types of front chassis bracket are selectable!! Just choose the suitable one. The Type A bracket can be changed to any direction you need.

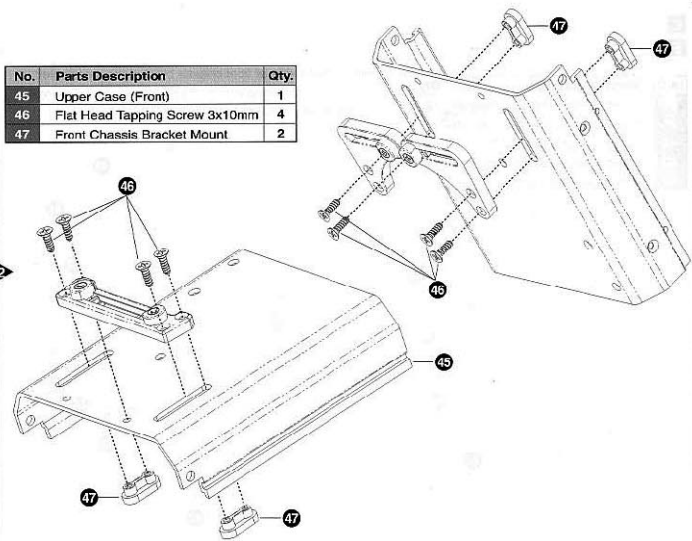
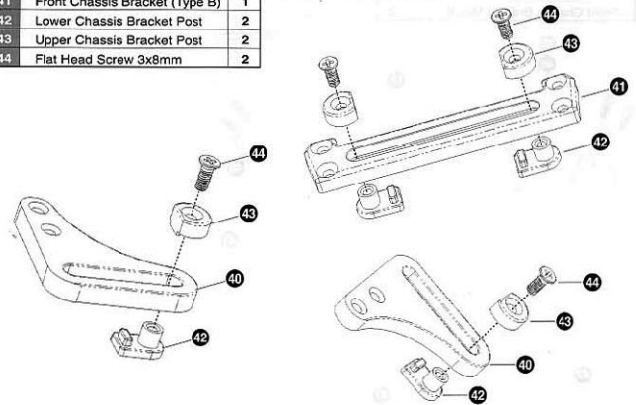

No.	Parts Description	Qty.
45	Upper Case (Front)	1
46	Flat Head Tapping Screw 3x10mm	4
47	Front Chassis Bracket Mount	2

No.	Parts Description	Qty.
48	Upper Pivot Mount	2
49	Flat Head Tapping Screw 3x8mm	2
50	Lower Pivot Mount	2
51	Big Round Head Tapping Screw 3x12mm	2

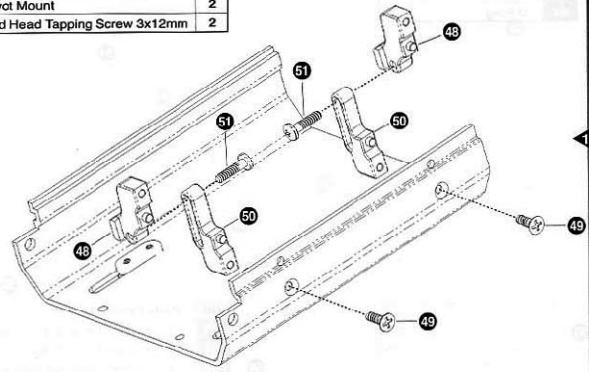

F. フロントサイドプレートの組立て

F Front Side Plate Assembly

No.	Parts Description	Qty.
52	Front Side Plate	1
53	Handle	1
54	O Ring	2

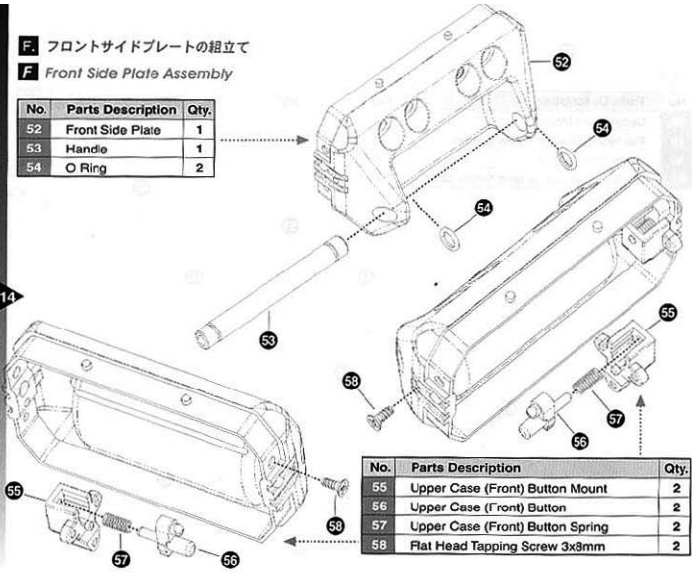

No.	Parts Description	Qty.
55	Upper Case (Front) Button Mount	2
56	Upper Case (Front) Button	2
57	Upper Case (Front) Button Spring	2
58	Flat Head Tapping Screw 3x3mm	2

G. リアサイドプレートの組立て

G Rear Side Plate Assembly

No.	Parts Description	Qty.
59	Rear Side Plate	1
60	Glow Starter Mount	1
61	Flat Head Tapping Screw 3x8mm	2

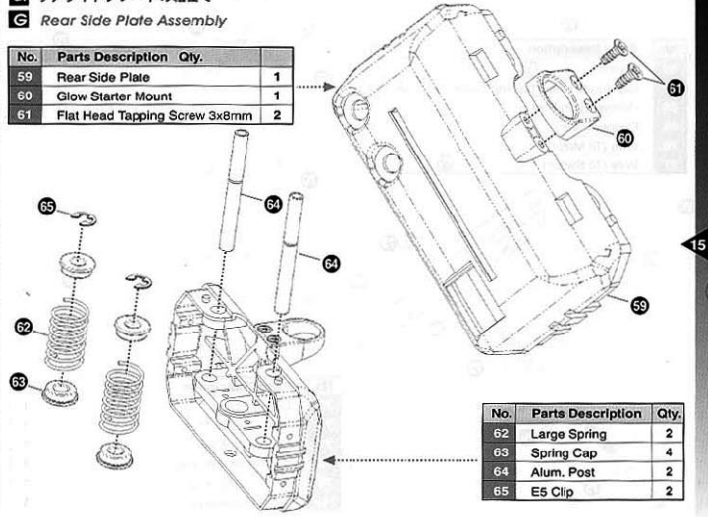

No.	Parts Description	Qty.
62	Large Spring	2
63	Spring Cap	4
64	Alum. Post	2
65	E5 Clip	2

No.	Parts Description	Qty.
66	Switch	1
67	Big Round Head Tapping Screw 3x10mm	2
68	Hollow Nylon Post	1
69	Copper Plate	2
70	Wire (To Motor)	1
71	Wire (To Switch)	1

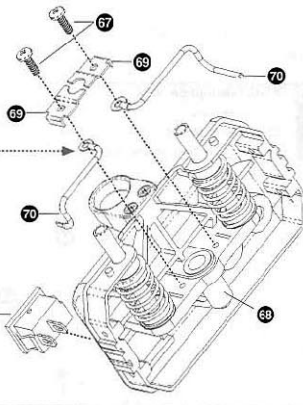

No.	Parts Description	Qty.
72	Timing Spring	1
73	Rear Chassis Bracket	1
74	Copper Washer	1
75	Cap Screw 4x50mm	1
76	Nylon Bushing (L)	1
76a	Nylon Bushing (S)	1

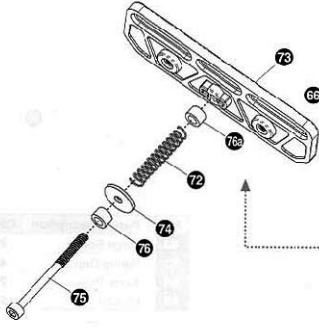

No.	Parts Description	Qty.
77	Lower Chassis Bracket Post	2
78	Upper Chassis Bracket Post	2
79	Flat Head Screw 3x8mm	2

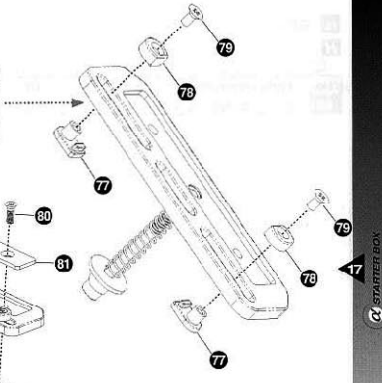

No.	Parts Description	Qty.
80	Flat Head Screw 4x13mm	2
81	Rear Chassis Bracket Stiffener	1
82	Wire (To Battery)	1

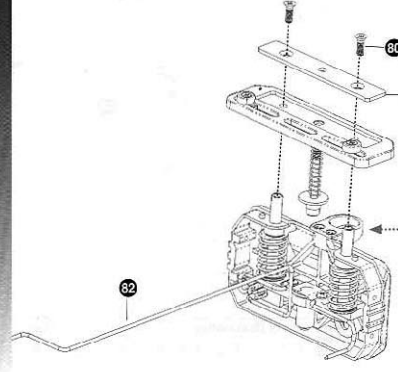

**H. 最終仕上げ**  
**H. Final Assembly**

No.	Parts Description	Qty.
83	Flat Head Tapping Screw 3x8mm	2

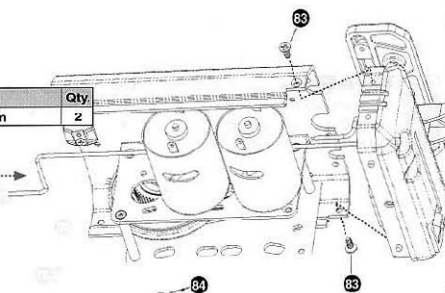

No.	Parts Description	Qty.
84	Flat Head Tapping Screw 3x8mm	2

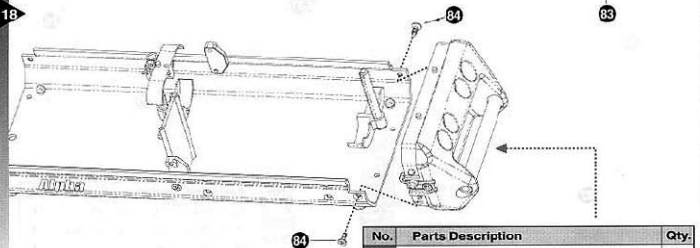

No.	Parts Description	Qty.
85	Flat Head Tapping Screw 3x8mm	2

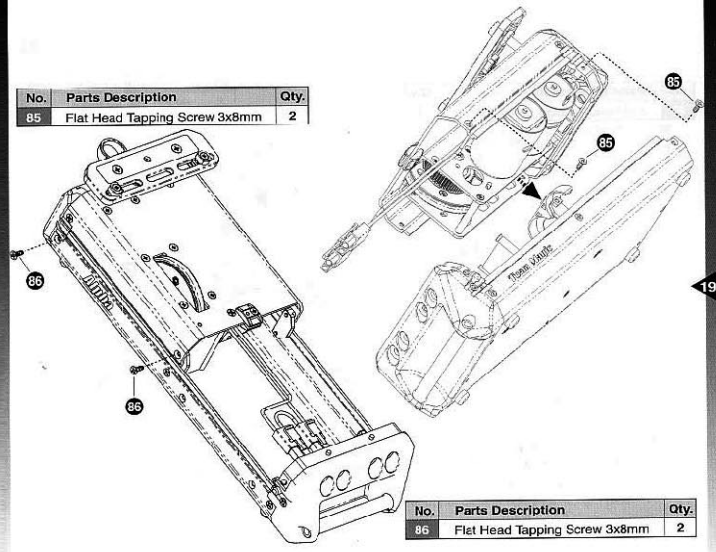

No.	Parts Description	Qty.
85	Flat Head Tapping Screw 3x8mm	2

No.	Parts Description	Qty.
87	Flat Head Tapping Screw 3x8mm	2

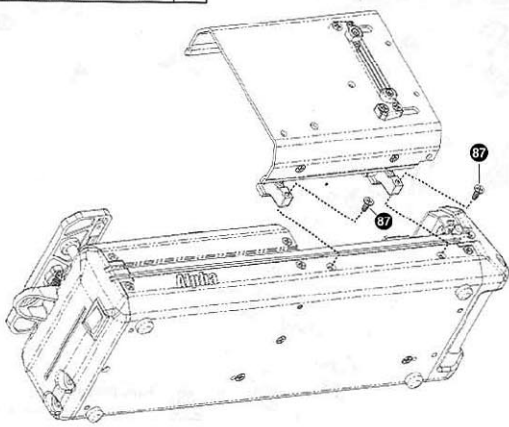

**I. アッパーケース前部の開閉の仕方**

No.	Parts Description	Qty.
88	Upper Battery Holder	2
89	R Clip	2

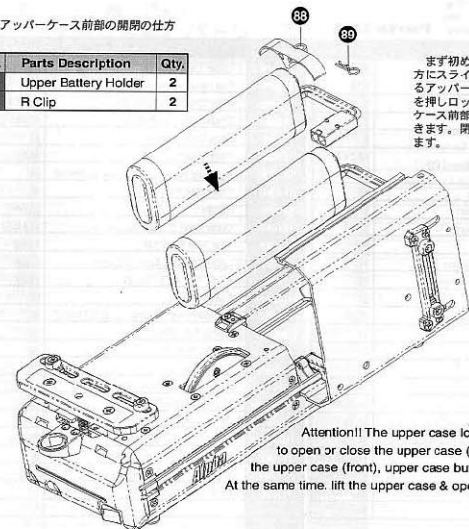

まず初めにアッパーケースロックを後方にスライドさせ、次に左右に付いているアッパーケース・ボタン（フロント）を押しロックを解除させます。アッパーケース前部を垂直に2cmほど持ち上げ開きます。閉める時は逆のステップで閉じます。

Attention!! The upper case lock should be backward moved to open or close the upper case (front). To open the upper case (front), upper case buttons should be pressed. At the same time, lift the upper case & open to the right side.

# HYPER STAR Parts List

Parts No.	Parts Description	Content	Parts No.	Parts Description	Content
111060	Reduction Gearb Set	1,4,5	111078	Upper Case Lock (2)	37
111061	Steel Post(1)	3,19	111079	Flat Head Screw 3x6mm (6)	39,9
111062	Rubber Starter Wheel	6	111080	Front Chassis Bracket Set	40,41,47
111063	S3T Main Gear(2)	7	111081	Chassis Bracket Post (4 pairs)	42,43,77,78
111064	3mm Flat Nut(6)	8	111082	Upper case (Front)	45
111065	Flat Head Screw 3x8mm (10)	20,24,38 44,79	111083	Pivot Mount set (2)	48,50
111035-2	Bearing 10x26x8mm	10	111084	Big Round Head Tapping Screw 3x12mm(2)	51
111066	Starter Wheel Post Set	11,12,13	111085	Front Side Plate	52
111025	Alum. Pulley Set (Short) (1)	14,16	111086	Handle	53,54
1110182	Motor (1)	15	111087	Upper Case (Front) Bracket Set	55,56,57
111066-1	Motor Mount Plate (Motor Side)	17	111088	Rear Side Plate Set	59,60
111035-5	Round Washer Head Screw	18	111027	Large Spring & Spring Can set	62,63
111067	Short Belt	21	111089	Alum. Post & ES Cile (2)	64,65
111068	Round Head Screw 4x10mm (2)	22,26	111034-1	Switch	66
111069	Long Belt	23	111097	Big Round Head Tapping Screw 3x10mm(2)	67
111070	Motor Mount Plate	25	111035-3	Hollow Nylon Post	68
111071	Lower Case	27	111090	Copper Plate (2)	69
111031	Rubber Cap (4)	28	111035-16	Timing Spring	72
111072	Battery Holder Set (2)	29,30,88,89	111091	Rear Chassis Bracket Set	73,81
111073	Flat Head Tapping Screw 3x10mm(10)	31,46	111035-15	Copper Washer	74
111074	Lock Bracket(Upper & Lower Case) (2)	32	111035-13	Cap Screw 4x50mm	75
111075	Flat Head Tapping Screw 3x8mm (10)	33,34,49,58,61 83,84,85,86,87	111035-14	Nylon Bushing (L & S)	76,76a
111076	Baffle	35	111092	Flat Head Screw 4x10mm (2)	80
111077	Upper Case (Rear)	36	111093	Wire Set For 12V Battery	
			111096	Photo Switch	

# HYPER STAR パーツリスト

パーツNo.	品名	相立図No.	パーツNo.	品名	相立図No.
111060	減速ギヤセット	1,4,5	111078	アッパーケース・ロック (2)	37
111061	スチールポスト(1)	3,19	111079	3x6mm鋼ビス (6)	39,9
111062	ラバースターターホイール	6	111080	フロント・シャシブラケットセット	40,41,47
111063	S3T メインギヤ(2)	7	111081	シャシブラケット・ポスト (4ペア)	42,43,77,78
111064	3mm フラットナット(6)	8	111082	アッパーケース (フロント側)	45
111065	3x8mm 鋼ビス (10)	20,24,38 44,79	111083	ピボットマウントセット (2)	48,50
111035-2	10x26x8mm ベアリング	10	111084	3x12mm ナベビス(2)	51
111066	スターターホイール・ポストセット	11,12,13	111085	フロント・サイドプレート	52
111025	アルミプーリーセット(ショート) (1)	14,16	111086	ハンドル	53,54
1110182	モーター (1)	15	111087	アッパーケースブラケット(フロント)	55,56,57
111066-1	モーターマウントプレート(モーター側)	17	111088	リア・サイドプレートセット	59,60
111035-5	ナベビス (ラウンドワッシャー)	18	111027	ラージスプリング&スプリングキャップセット	62,63
111067	ショートベルト	21	111089	アルミポスト & 5mmEリング (2)	64,65
111068	4x10mm ナベビス(2)	22,26	111034-1	スイッチ	66
111069	ロングベルト	23	111097	Big Round Head Tapping Screw 3x10mm(2)	67
111070	モーターマウントプレート	25	111035-3	Hollow Nylon Post	68
111071	ローケース	27	111090	銅プレート (2)	69
111031	ラバーキャップ (4)	28	111035-16	タイミングスプリング	72
111072	バッテリーホルダーセット (2)	29,30,88,89	111091	リアシャシブラケットセット	73,81
111073	3x10mm 鋼ビス タッピング(10)	31,46	111035-15	銅ワッシャー	74
111074	ロック・ブラケット(ケース上下用) (2)	32	111035-13	キャプスcrew 4x50mm	75
111075	3x8mm 鋼ビス タッピング(10)	33,34,49,58,61 83,84,85,86,87	111035-14	Nylon Bushing (L & S)	76,76a
111076	内部固定プレート	35	111092	4x10mm 鋼ビス(2)	80
111077	アッパーケース(リア側)	36	111093	12V入力用コードセット	
			111096	マイクロスイッチ	